

11/16/11
#12053
PARAMOUNT FARMS
42SP465LAH

DEVINER
112-1058
28-006-5762

FP55-314MPT

SECONDARY
112-1058
28-006-5762

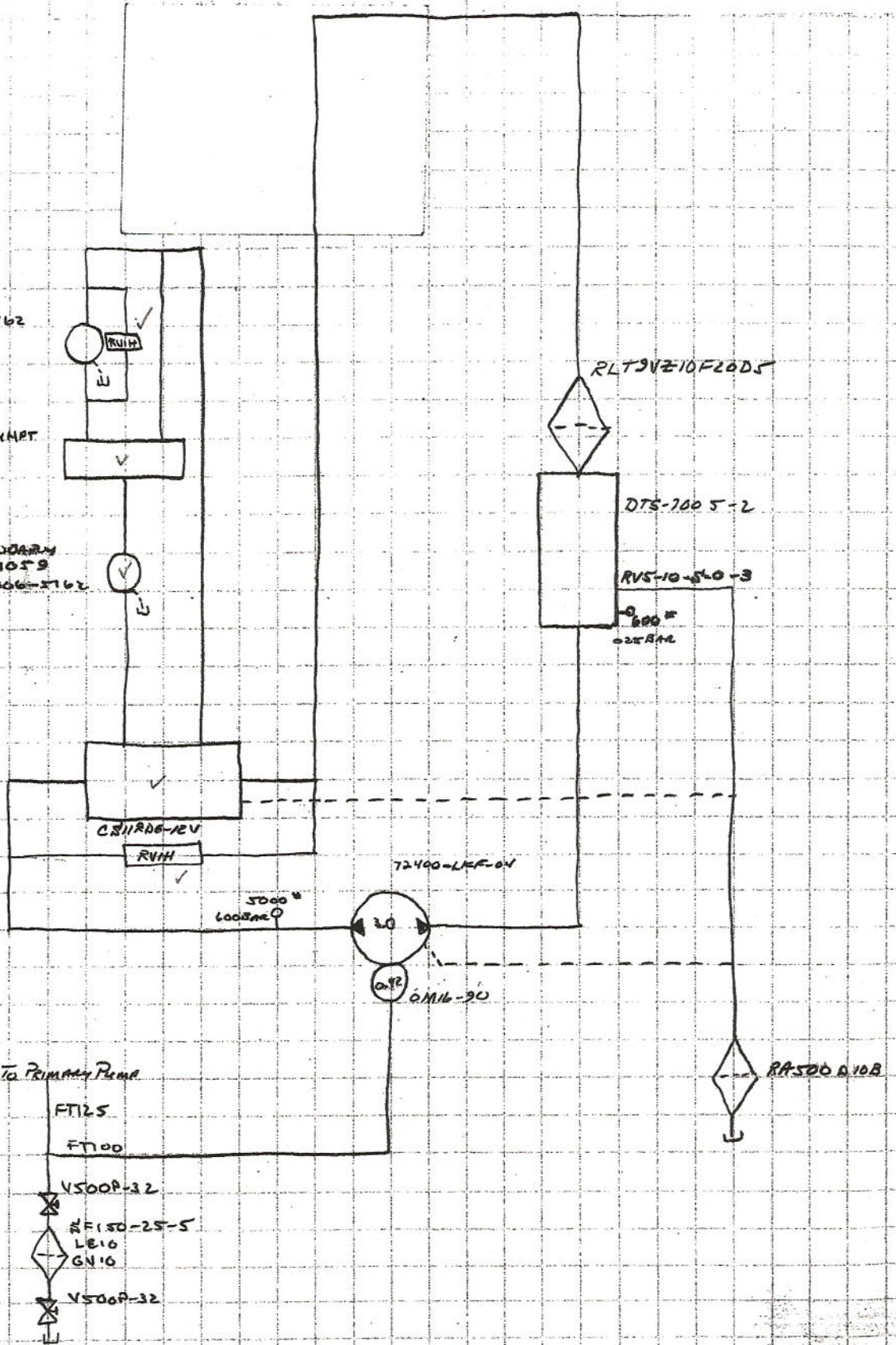

- ④
 TF2540-3
 2 1/2" 90° STEEL
 2 1/2" CLS NIP
 2BNL20-40B
 FT250
 * JSVQTRB
- ③
 3" X 2" BUSH
 2" CLS NIP
 V500P-32
 FT200
 ORF 32-90
 FF200
 2" 90° STEEL
 W48-32PK
 20F2215-25-5
 W43-32PK
 2" 90° STEEL
 2" CLS NIP
 V500P-32
 2" CLS NIP
 2" TEE X
 2" X 1 1/4" BUSH
 X FT125
 * TL 1/4" * L.YEE

- ③
 TF2030-3
 2" 90° STEEL
 2" CLS NIP
 V500P-32
 2" CLS NIP
 2" TEE X
 * Y2AK
- ③
 TF2030-3
 2" 90° STEEL
 2" CLS NIP
 V500P-32
 2" CLS NIP
 2" TEE X
 X 2" X 1 1/2" BUSH
 FT150
 * TRIPLE COMB
 2" 90° STEEL
 2" X 1 1/2" BUSH
 FT150
 * TRIPLE COMB

- ③
 TF2030-3
 2" 90° STEEL
 2" CLS NIP
 V500P-32
 2" CLS NIP
 2" TEE X
 X 2" X 1 1/4" BUSH
 FT125
 * PLP20.20
 2" 90° STEEL
 2" X 1" BUSH
 FT100
 * VID

- ④
 4" X 2" BUSH
 2" 90° STEEL
 2" CLS NIP
 V500P-32
 2" X 1 1/2" BUSH
 1 1/2" CLS NIP
 SF150-25-5
 1 1/2" CLS NIP
 2" X 1 1/2" BUSH
 V500P-32
 2" CLS NIP
 2" TEE X
 FT125
 * TANDEM 3.0EE
 2" 90° STEEL
 2" X 1" BUSH
 FT100
 * SINGLE 3.0EE

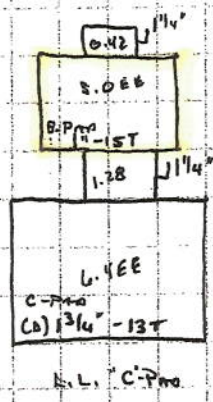
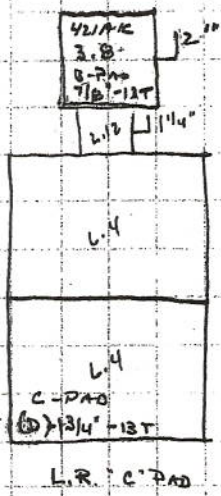

- L.R. TANDEM L.Y
 Y2AK
 L.L. L.YEE
 3.0EE
 T.R. JSVQTRB
 TRIPLE COMB
 T.L. TANDEM 3.0
 PLP20.20
 ENGINE VID

- SHOWN DRIVE
 STEERING CIRCUIT
 AIR HEAD
 SECONDARY
 CROSS SIDE
 BIN FULL
 BIN UNLOADED
 LEFT START TABLE
 LEFT PRIMARY
 RIGHT PRIMARY
 RIGHT START TABLE
 BRAKE CHANGE PRESSURE
 FLIGHTING

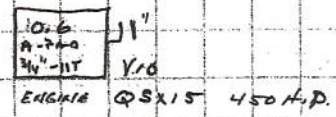
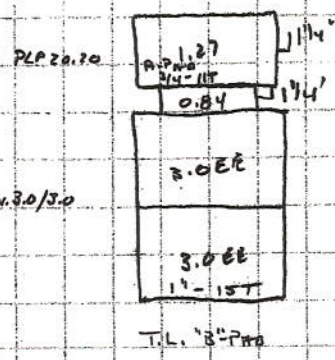
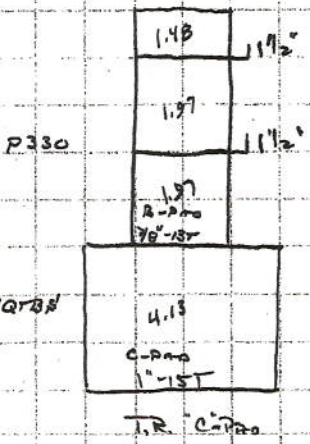

DURST D13387 4P02-120E-NV-BCCA-CON-CHA-CHA-15
 DRIVE PLATE - TORSION SPRINGS 19310

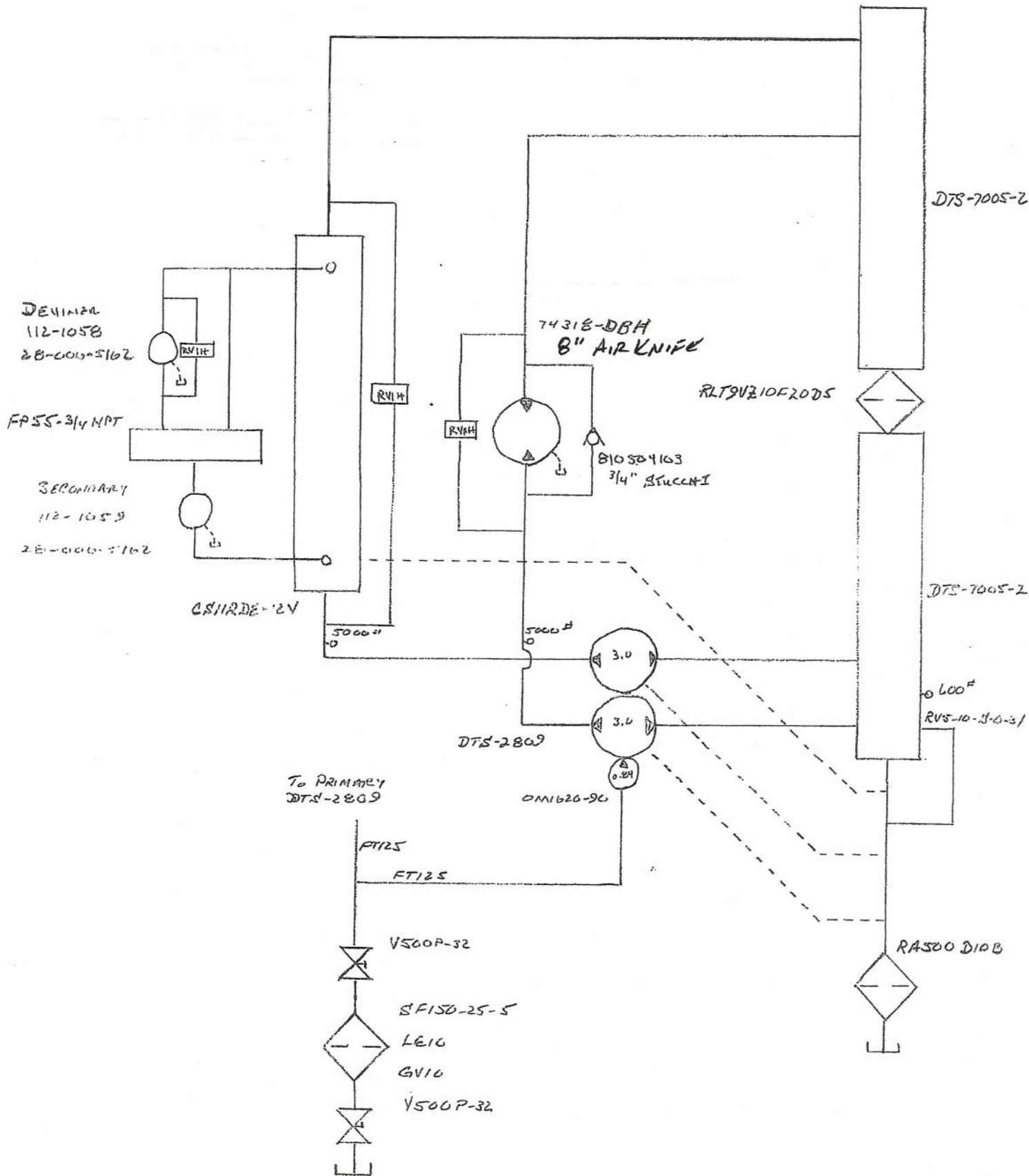

<p>4"</p> <p>TF2540-3</p> <p>2 1/2" 90° STEEL</p> <p>2 1/2" C/S N/A</p> <p>2 BVZ 20-40B</p> <p>FT250</p> <p>† 35VQTB'S</p>	<p>3"</p> <p>3 1/2" BUSH</p> <p>2" C/S N/A</p> <p>V500P-32</p> <p>FT200</p> <p>ORF-32-90</p> <p>ZDF2215-25-1/5</p> <p>W43-32 P/A 2"</p> <p>2" 90° STEEL</p> <p>2" C/S N/A</p> <p>V500P-32</p> <p>2" C/S N/A</p> <p>2" TEE</p> <p>X 2" X 1 1/2" BUSH</p> <p>2" X 1 1/2" BUSH</p> <p>2404-24-24</p> <p>2" X 1 1/2" BUSH</p> <p>2404-20-20</p> <p>† C136 (P/A 1000) † 6422-265</p>	<p>3"</p> <p>TF2030-3</p> <p>2" C/S N/A</p> <p>V500P-32</p> <p>2" 90° STEEL</p> <p>FT200</p> <p>† 421AK</p>	<p>3"</p> <p>TF2030-3</p> <p>2" C/S N/A</p> <p>V500P-32</p> <p>2" 90° STEEL</p> <p>2" C/S N/A</p> <p>2" TEE</p> <p>2" X 1 1/2" BUSH</p> <p>2404-24-24</p> <p>P330</p> <p>2" 90° STEEL</p> <p>2" X 1 1/2" BUSH</p> <p>2404-24-24</p> <p>P330</p> <p>† V10</p>	<p>3"</p> <p>TF2030-3</p> <p>2" 90° STEEL</p> <p>2" C/S N/A</p> <p>V500P-32</p> <p>2" C/S N/A</p> <p>2" TEE</p> <p>X 2" X 1 1/2" BUSH</p> <p>2404-24-24</p> <p>† S12B274</p> <p>2" 90° STEEL</p> <p>2" X 1" BUSH</p> <p>2404-16-16</p> <p>† V10</p>	<p>4"</p> <p>4" X 2" BUSH</p> <p>2" 90° STEEL</p> <p>2" C/S N/A</p> <p>V500P-32</p> <p>2" C/S N/A</p> <p>1 1/2" C/S N/A</p> <p>SF150-25-1/5</p> <p>1 1/2" C/S N/A</p> <p>2" X 1 1/2" BUSH</p> <p>V500P-32</p> <p>2" C/S N/A</p> <p>2" TEE</p> <p>X 2" X 1 1/4" BUSH</p> <p>1 1/4" 45° STEEL</p> <p>2404-20-20</p> <p>† DTS-2809</p> <p>2" X 1 1/4" BUSH</p> <p>2404-20-20</p> <p>† DTS-2809</p>
--	---	---	--	---	---

- L.R. - C136
- 421AK
- LL. - 6422-265
- DTS-2809 - FRONT - SLOTTED DAMPER
- REAR - CRACK FAN
- T.R. - 35VQTB'S - F.D. - CROSS
- F.D. - AIRFLOW FLOW
- P330 - FRONT - BIN UNLOAD
- MID - BIN FILL
- REAR - LEFT STAR
- T.L. DTS-2809 - FRONT - RIGHT PAIN 4
- REAR - LEFT PAIN 4
- S12B274 - FRONT - RIGHT STAR/STEEL
- REAR - RIGHT STAR DIST.

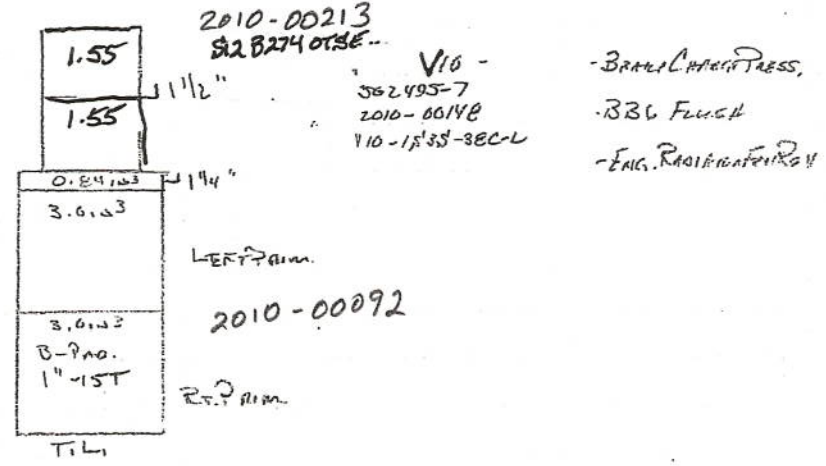
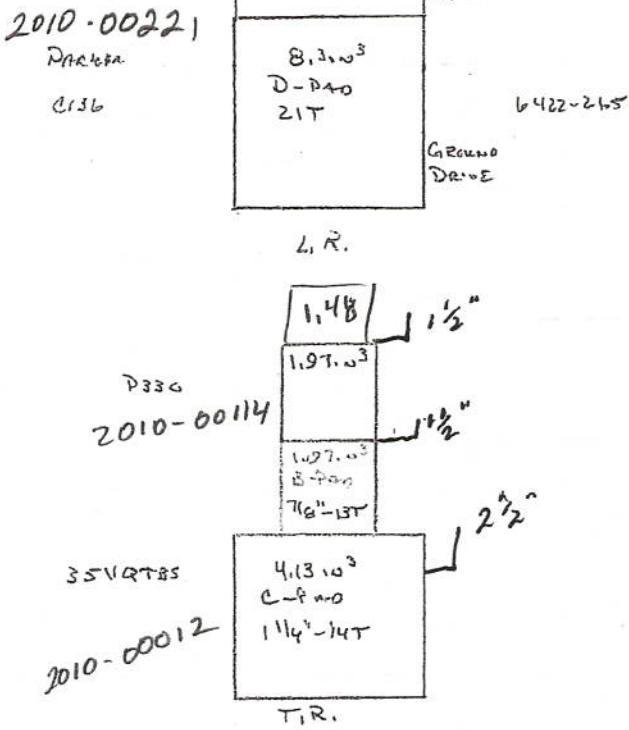
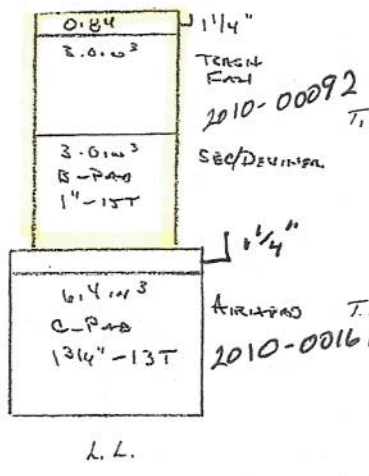
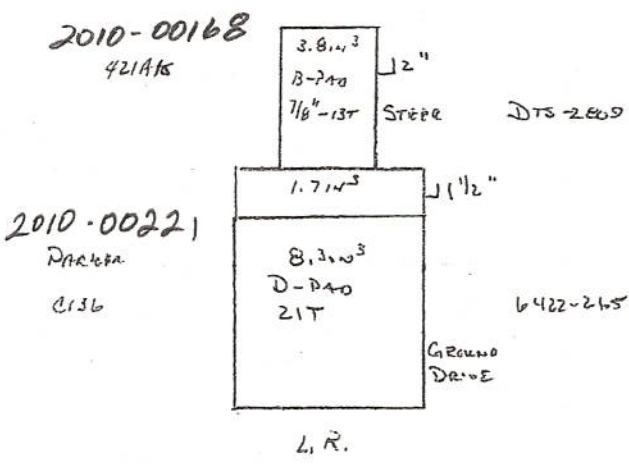

DIRECT 4P009-120 I-NII-BB6H-CH-CEH-DEH-L5I
DRIVE PLATE TORSION CONTACTS 19310
CAMMINS Q8X15 520 HP REGRASING FAN 210CRPM

CHECK TORQUE ON OIL PAN
PLUGS PRIOR TO FILLING WITH OIL

Cummins ReCon[®] Diesel Warranty

	ACCEPTED
 QUALITY ASSURANCE	ACCEPTED DATE <u>07-20-16</u>
REV. 01	FORMA IF-009

L10/M11/ISM/N/N14/VT903
Engines Worldwide

	
Diesel ReCon Company A Division Of Cummins Engine Company, Inc.	
	PART NUMBER (P) DR1487RX
	SERIAL NUMBER (S) 60540305
MODEL N14	WAREHOUSE MEM

Big Iron PO # 46164 // 050996

CAUTION

CHECK TORQUE ON OIL PAN
PLUGS PRIOR TO FILLING WITH OIL



Cummins ReCon[®] Diesel Warranty



ACCEPTED

Sanford

QUALITY
ASSURANCE

ACCEPTED DATE: 06-11-2017

EV. 01

FORMA IF-009

ICX/QSX Engine
Warranty Certificate

 Diesel ReCon Company A Division Of Cummins Engine Company, Inc.	
	PART NUMBER (P) DR6338RX
	SERIAL NUMBER (S) 60819951
MODEL QSX	WAREHOUSE MEM

Roger, Pat

Vickers V35 Pump

2010-00012

Defective

20 GPM @ idle

Rev motor up it drops to
Zero.

"New off shelf"

